



Reynaers
Aluminium

Reynaers Product Presentation

Product Overview

Innovative & Forward Thinking

- Reynaers products offer excellent thermal insulation, weather proofing and smart home access control to deliver **Comfort** to the end-user. SlimLine solutions and robust, strong systems anticipate on the **Aesthetical** trend of slim sight lines and large glass surfaces. Personal **Safety** in homes and public buildings is guaranteed via anti-burglar, fire and smoke containment, emergency evacuation and bulletproof solutions.
- Via BIM models, online platforms for architects, fabricators and sales representatives Reynaers supports a fully **Digitalised** chain of product selection, ordering and production information and support. ReynaFlow assist the fabricator in the **Industrialisation** of the production- and workflow and helps reduce production waste.



COMFORT

DAYLIGHT ACCESS, WEATHER PROOFING, ACOUSTIC INSULATION AND BUILDING AUTOMATION



Reynaers
Aluminium

COMFORT

- Daylight access, thermal insulation, draft reduction, acoustic insulation are key ingredients to ensure a healthy and comfortable interior climate.
- Reynaers Aluminium offers a complete range of products that meet with the best proven performances to meet with the requirements of today and tomorrow:
- Low energy solutions
- MasterLine and SlimLine windows and doors
- MasterPatio Sliding systems
- CW 50-HI curtain wall solutions
- Ergonomic handles

The average person spends 22 hours, or 90% of their day, indoors



COMFORT: CW 50 HI



Ultimate thermal comfort

- **Multi functional insulators** provides; insulation, guidance for extra long screws, drainage.
- **No butyl tape** required
- Designed for **glass thicknesses up to 61 mm**
- Insulation level for 44 mm glass: **$U_f = 0.72 \text{ W/m}^2\text{K}$** vs Standard: $U_f = 1.7 \text{ W/m}^2\text{K}$. Down to $0.56 \text{ W/m}^2\text{K}$ for 60 mm glass
- Can be **integrated in Standard, SL, AOS, TT, RA and AP**

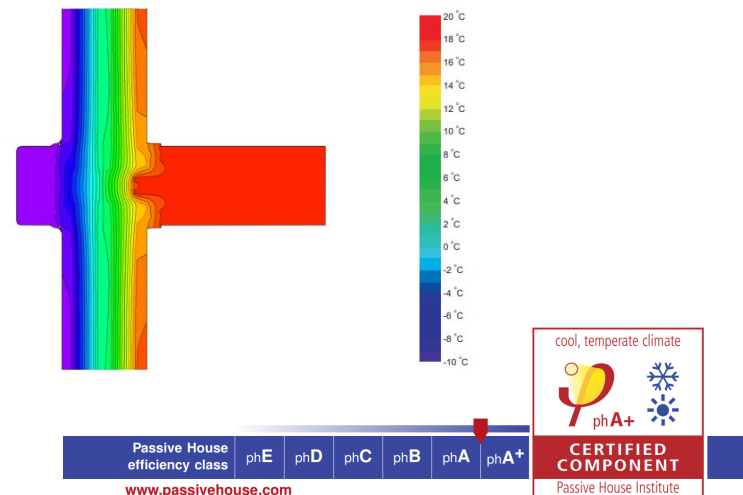

COMFORT: MASTERLINE WINDOWS AND DOORS

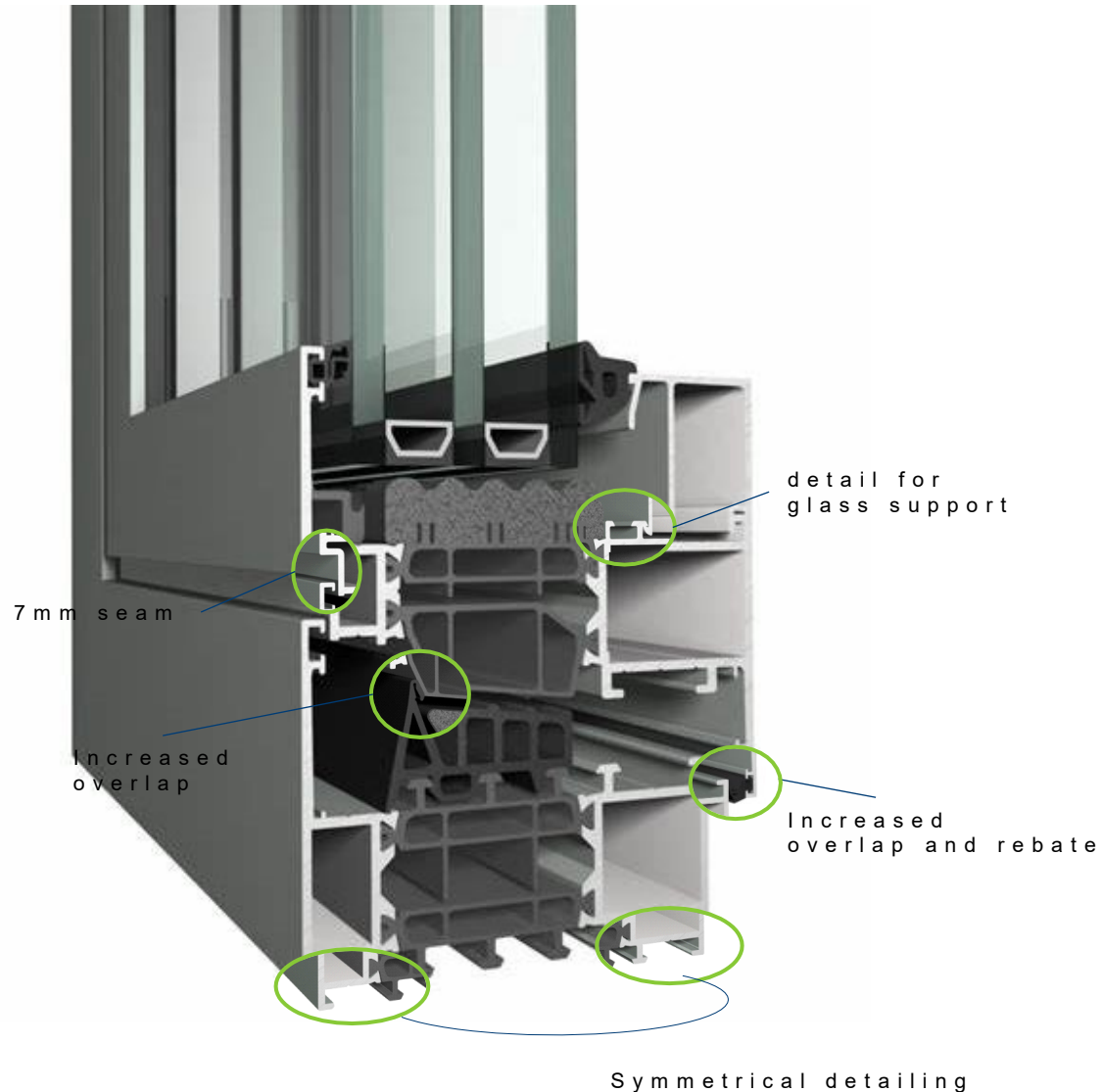

A NEW PLATFORM → A NEW PROFILE 'DNA'

- For a future proof, flexible and reliable platform MasterLine has been redesigned from the ground up:
- An enlarged rebate of 27mm to allow for a bigger overlap of the central gasket for increased reliability and performances
- Strengthened profiles for increased dimensions and glass weights
- Symmetrical detailing on frames for increased connectivity and flexibility

MasterLine 8 SoftTone is the **sustainable architectural solution** for natural cooling and ventilation in urban environments. The parallel opening window units allow maximal ventilation and cooling, the SoftTone components inside the window reduce the noise nuisance. This results in **fresh and healthy living** in the heart of a vibrant city.

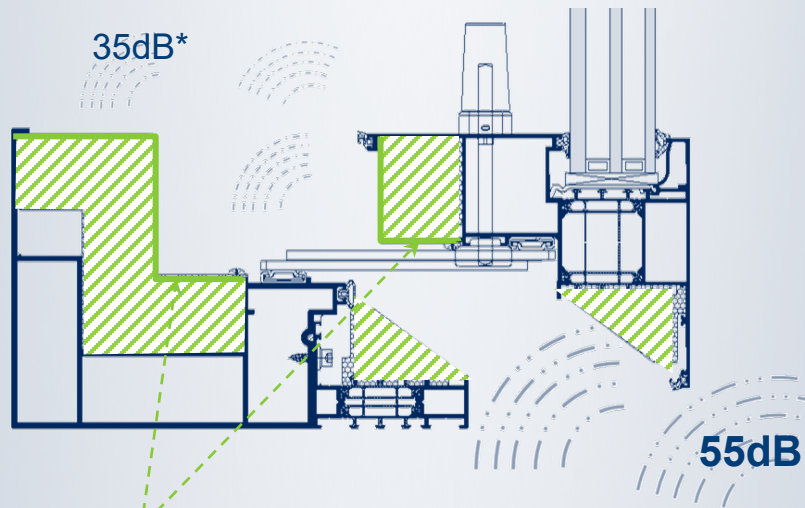

Basic principle: create an acoustically lined tortuous air path

1. The aluminum extrusions are adapted to allow the sound absorbing material () to be included.
2. The appearance of the system has been maintained by covering the acoustic foam with a perforated metal that is 30% open.

*) interior noise level with a built-in, opened SoftTone element. The noise level reduction of -20dB is a result of the composed acoustic insulation of the facade + the (opened) SoftTone element

COMFORT: MASTERPATIO

- With the introduction of MasterPatio, we continue to push our efforts to remain the system of choice for fabricators and installers.
- We combined our expertise and knowledge with feedback from our fabricators and architects over the last years, to develop the next level sliding system.
- Key design drivers were ease and speed of manufacturing, superior thermal and water performances, clean aesthetics, sustainable efforts, and compatibility with the MasterLine 8 system.
- The fabrication has been improved with larger tolerances, easy positioning of components, installation without interruptions, shared components with MasterLine 8, and an intelligent drainage concept.

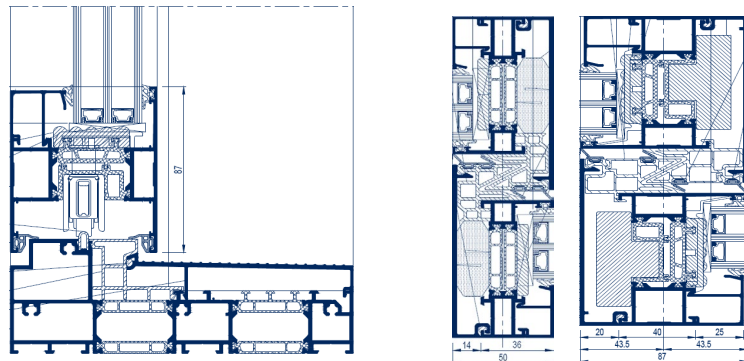
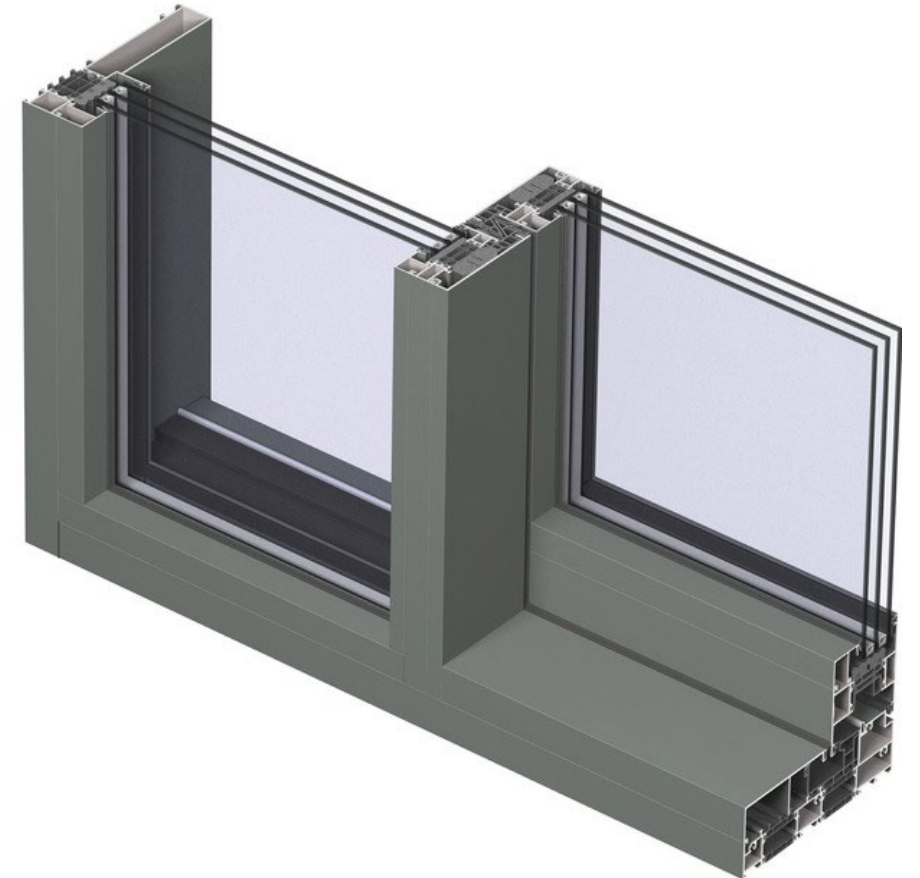

Insulated 41mm
Vent depth 76 mm
Frame depth 180mm
Meeting section 87 mm (Slim
Chicane 50 mm)
Glazing 16-62mm

MasterPatio – Cradle to Cradle Certified



Certification Number
5109

Standard Version
3.1

Lead Assessment Body
EPEA GmbH - Part of Drees &
Sommer

Material Health
Assessment Body
EPEA GmbH - Part of Drees &
Sommer

Effective Date
01 October 2021

Expiration Date
10 January 2023

Reynaers Aluminium

has successfully achieved Cradle to Cradle Certified® Bronze
for the product(s) under the name:

Reynaers Aluminium window, door and façade systems

Door frame systems: CS 77 and CS 77-AP door range in all insulation variants; SL 38 in all insulation variants; Masterline 8 in standard, HI and HI+ insulation variants; Locks, hinges, glass supports, and glass are added separately to these door frame systems

Window frame systems: CS 77, CS 77-AP and CS 77-HV in all insulation variants; SL 38 in all insulation variants; Masterline 8 in standard, HI and HI+ insulation levels in 4 design variants; Door locks, hinges, glass supports, and glass are added separately to these window frame systems

Curtain wall frame systems: CW 50-HI; CW 86-EF; Glass is added separately to these curtain wall frame systems.

Sliding door systems: MasterPatio; Door locks, glass supports and glass are added separately to these sliding door systems



President & CEO

Cradle to Cradle Products Innovation Institute

COMFORT: MOTORIZATION, ACCESS CONTROL

- Motorization:
 - HFP motor & lock
 - Siegenia lift & slide motor
 - D+H chain motors
- Access Control
 - Electrical locks
 - Fuhr
 - E-Opener
 - Finger scanner & key-pad
- Support operating large and heavy elements
- Control multipoint locking on doors and sliding elements
- Access control
- Automated natural ventilation of opening elements





AESTHETICS

SLIM SIGHTLINES, LARGE GLASS SURFACES, AND
ACCENTUATION



Reynaers
Aluminium

AESTHETICS: REFINED DAYLIGHT ACCESS

- Reynaers offers a range of slimline solutions that allows a homeowner to enjoy the changing effect of light and shadows and the refinement of aluminium joinery in both modern as more traditional architecture.
- Slimline solutions
- Hifinity sliding system
- MasterPatio Slim Chicane sliding system
- SlimPatio 68 sliding system
- SlimLine 38 windows and doors
- CW 50 SL and SC curtain wall
- Purity and Touch handles





HI FINITY

Meeting Section 35mm | Triple Glazing 60 mm | Motorized elements
up to 750 KG | Concealed Motorization



Reynaers
Aluminium

HI-FINITY – NEW FEATURES

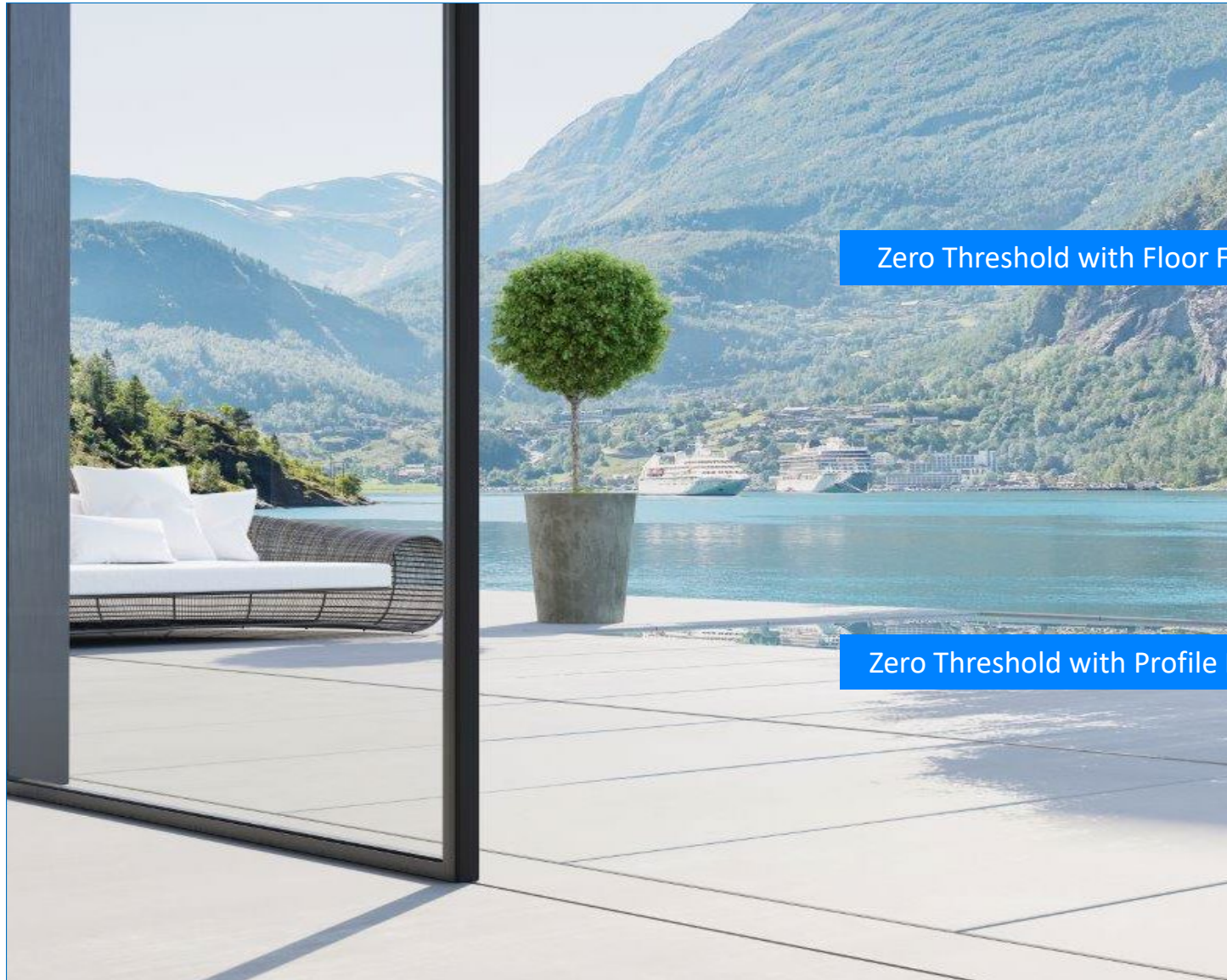

Zero Threshold with Floor Finish

Zero Threshold with Profile Finish

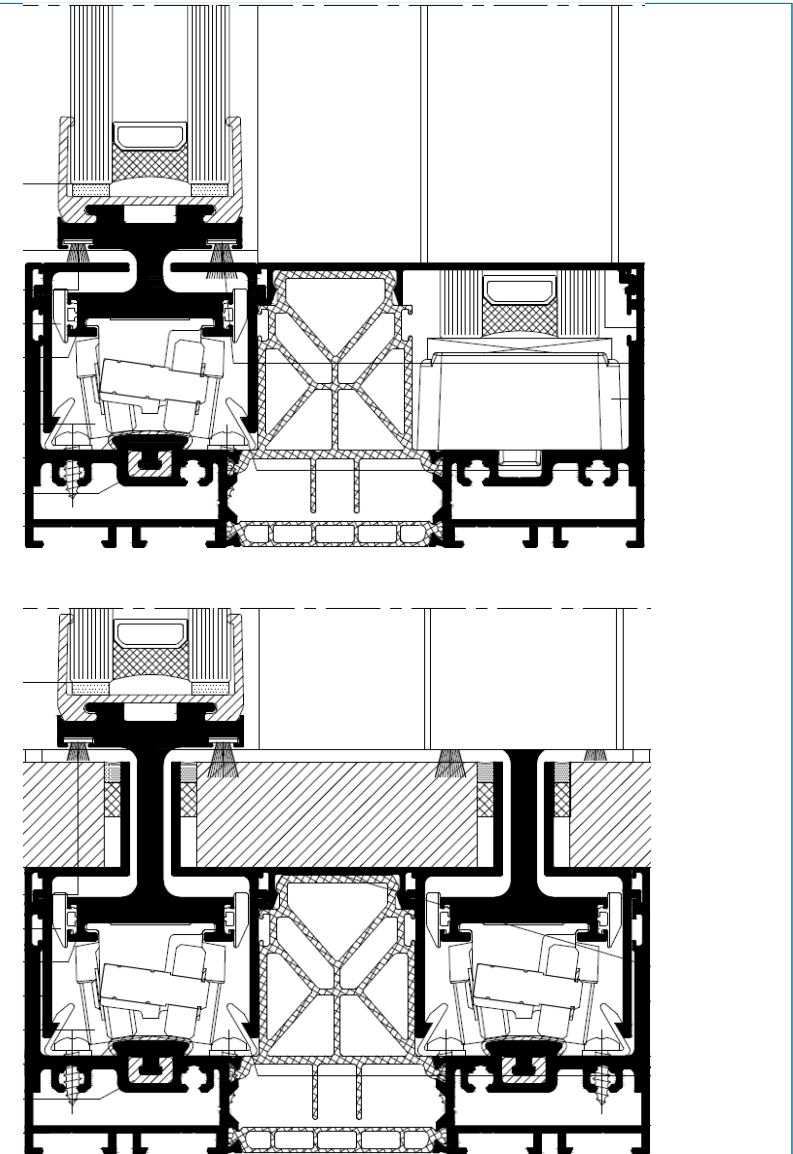

HI-FINITY – NEW FEATURES



AESTHETICS: SL 38

- Terrace doors, incl. UltraSlim doors
- New reinforced frames & Transoms
- New 17 mm Georgian Bars
- New rebate thicknesses allowing for 3m heights



ULTRA SLIM DOORS: PICTURES FROM BAU

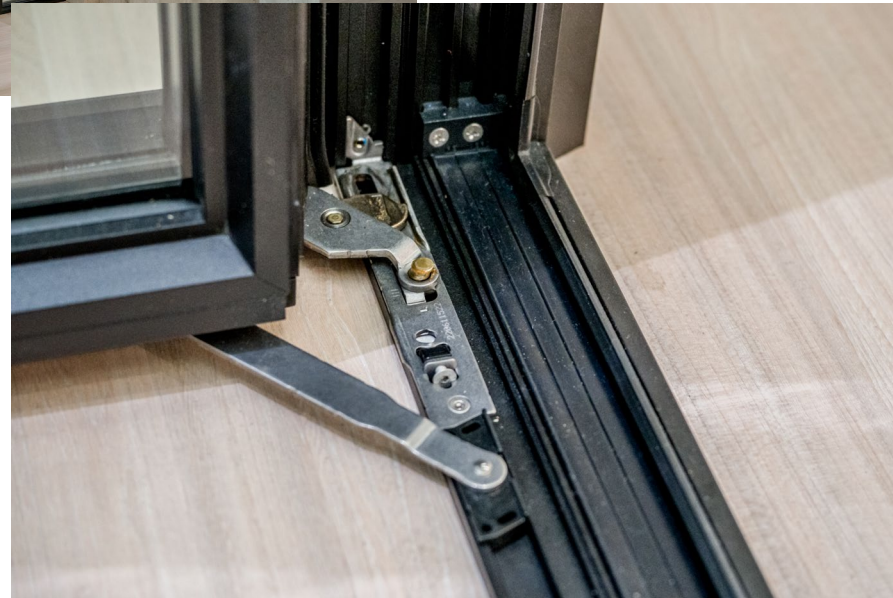



MASTERLINE PIVOT LANDSCAPE

THE NEW WAY OF ENTERING



Reynaers
Aluminium

MASTERLINE XL AND LANDSCAPE PIVOT DOOR

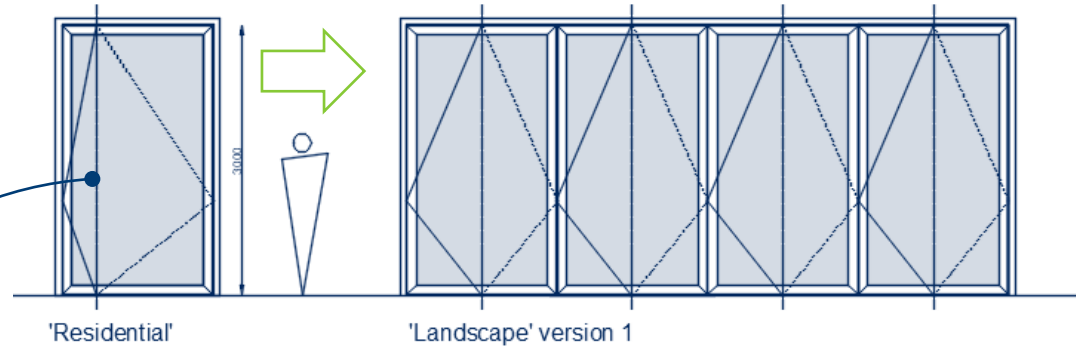

'Residential'

'Landscape' version 1

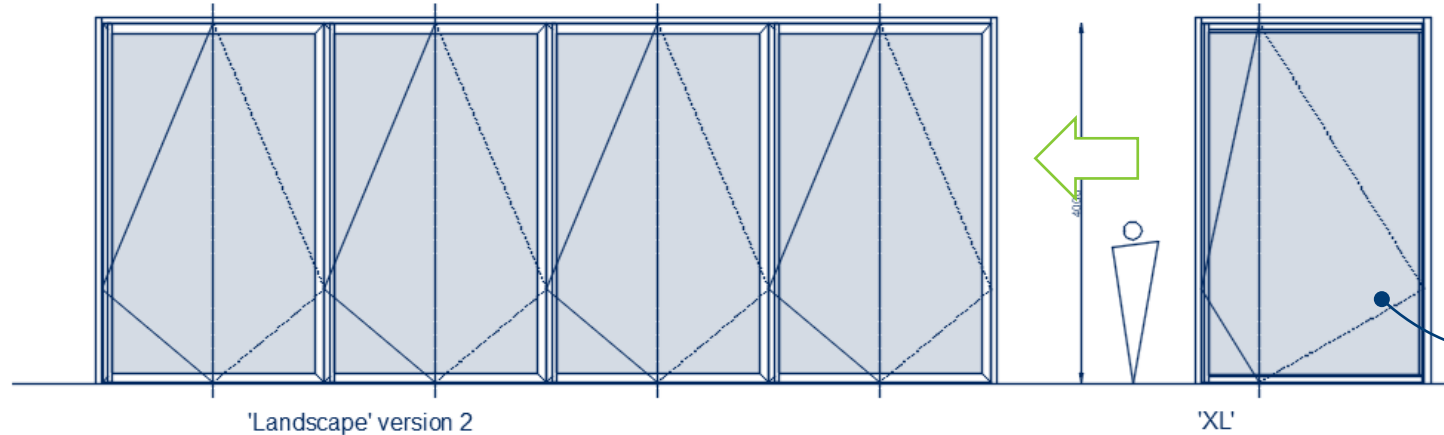

'Landscape' version 2

'XL'

'XL'

High end domestic entrance doors

- Motorised locking
- With slim side profiles lines of $\pm 40\text{mm}$!
- With integrated door closer and damper
- Max 2,5x4m @500kg

'Residential'

Domestic entrance doors:

- Burglar proof
- Synchronised locking
- With panel or glass
- Air and water tight and high insulating
- With door closer and damper
- Max 1,7x3m @200kg
- Sight line for sash of 104,5mm

'Landscape'

Multiple versions of either 'Residential' or 'XL' door for Horeca, convention centres, stadiums, private terraces:

- Symmetrical or alternating configuration
- High insulating
- Manual locking and fixing in opening position
- Sight line meeting section of 215mm (to be able to fit locks and handles to operate)

Launched

Objective:
Dec-Jan

MASTERLINE PIVOT DOORS OPENING TYPES

INWARD or **OUTWARD**

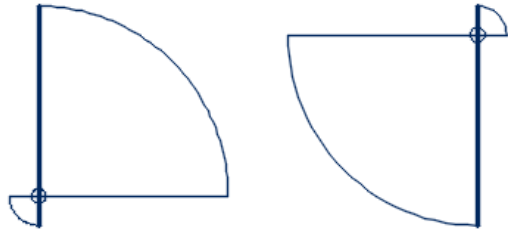

Available in
'Residential' and 'XL'

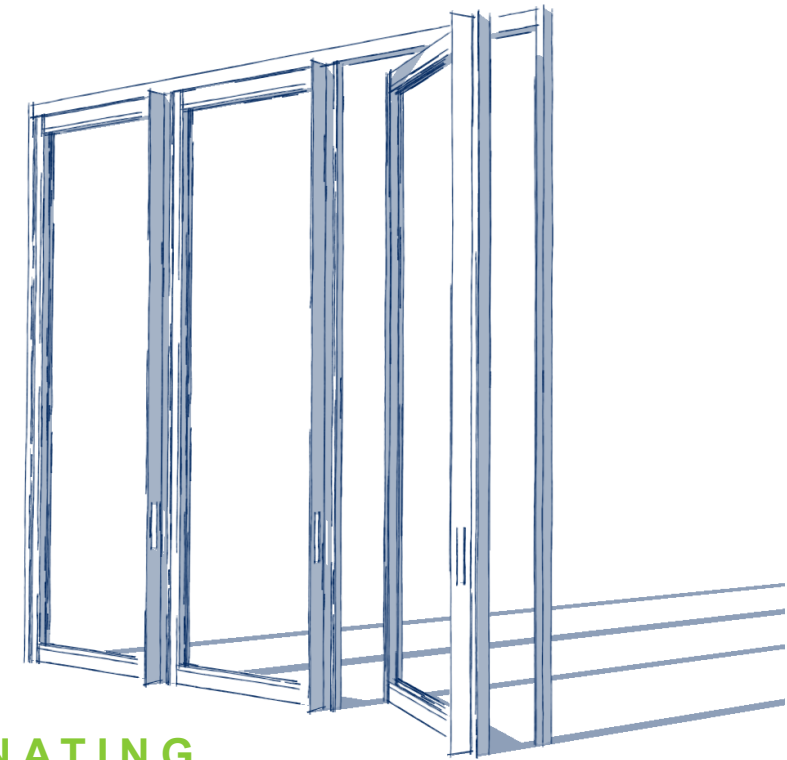

MIRRORED

or

ALTERNATING

ASYMMETRIC

Bigger opening

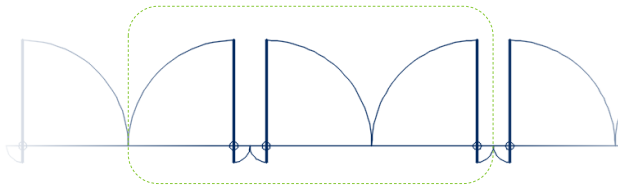

SYMMETRIC

More balanced appearance

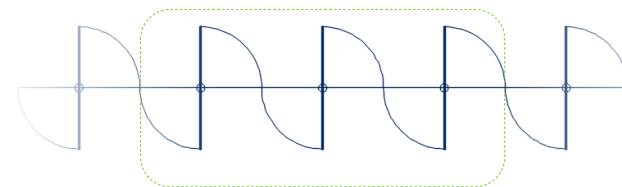
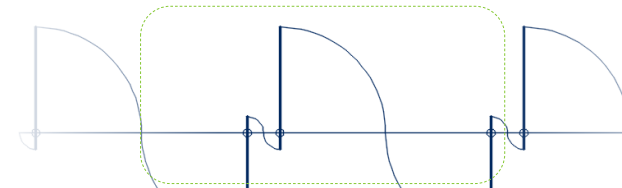
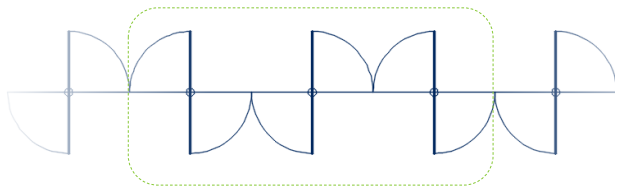

Available* in
'Landscape'

*) 2 or 3 = standard solution
More than 3 = project solution



Reynaers Act

SUSTAINABILITY



Reynaers
Aluminium

Buildings

Let's contribute to more sustainable buildings

The facts

In 2019, buildings all over the world consumed 35% of our global energy consumption and 55% of our global electricity use.

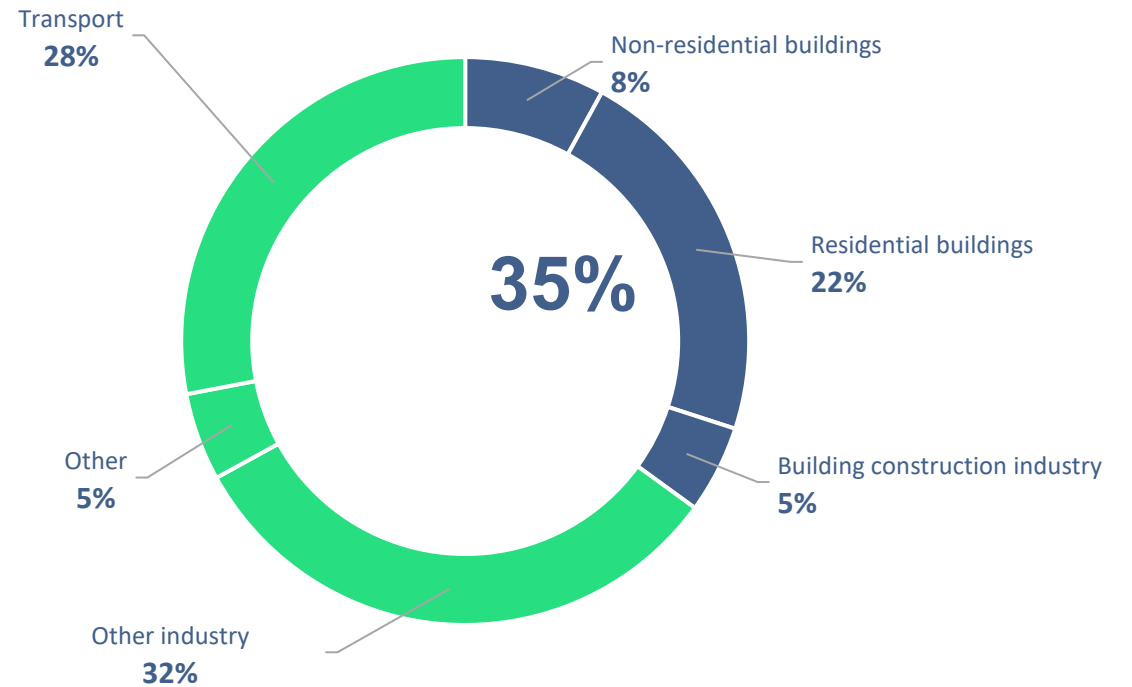

Energy



Act 1

Expanding certification on thermal performance

To demonstrate our ambition, we are constantly expanding the amount of Passive House certified systems and other certifications such as Minergie within the Reynaers Aluminium offering. These certifications are meant to ease component selection in the design of energy-efficient buildings.

Act 2

Integrating sustainability data in our digital tools

Our business partners should have easy access to all the information they need to design a sustainable building. How? By expanding BIM and introducing a Digital Passport, in which we will add the necessary sustainability information. That way, we can ease communication and coordination between architects, engineers and contractors.

Act 3

Guiding our partners towards a holistic sustainability approach

Reynaers contributes to sustainable living and working. We support the sector with information, education and performant products

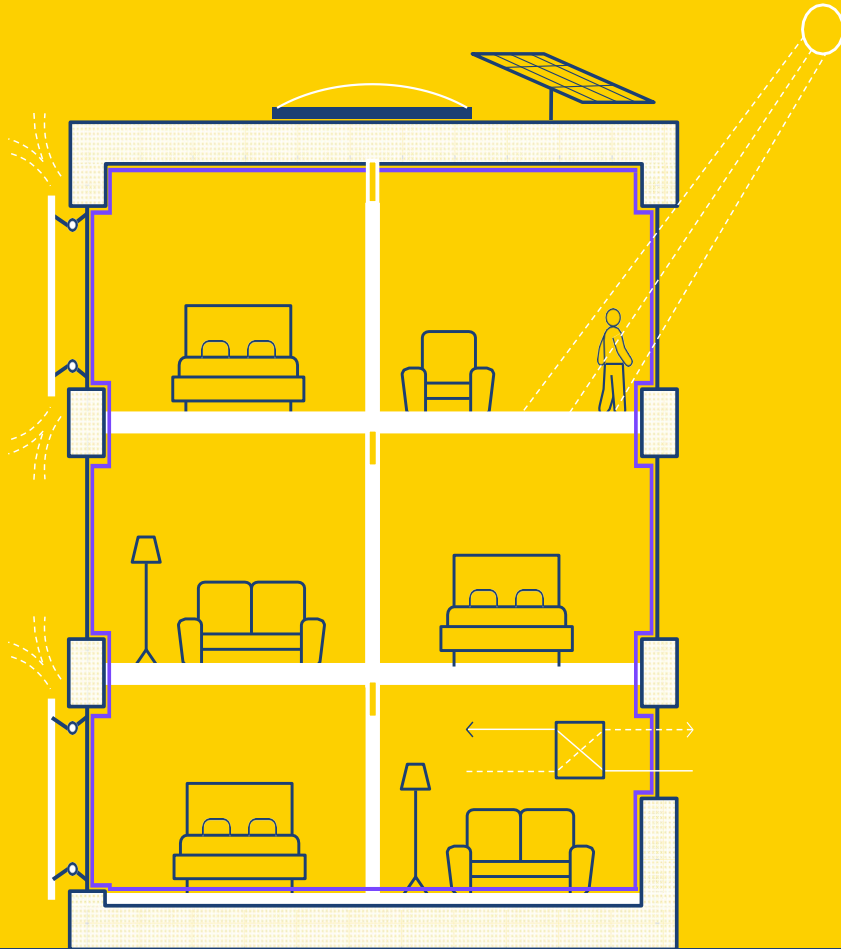

Products

Let's develop circular products

The facts

Construction materials account for 47% of the EU's overall consumption of materials by weight. Increasing the circularity of these products could reduce the environmental impact significantly.

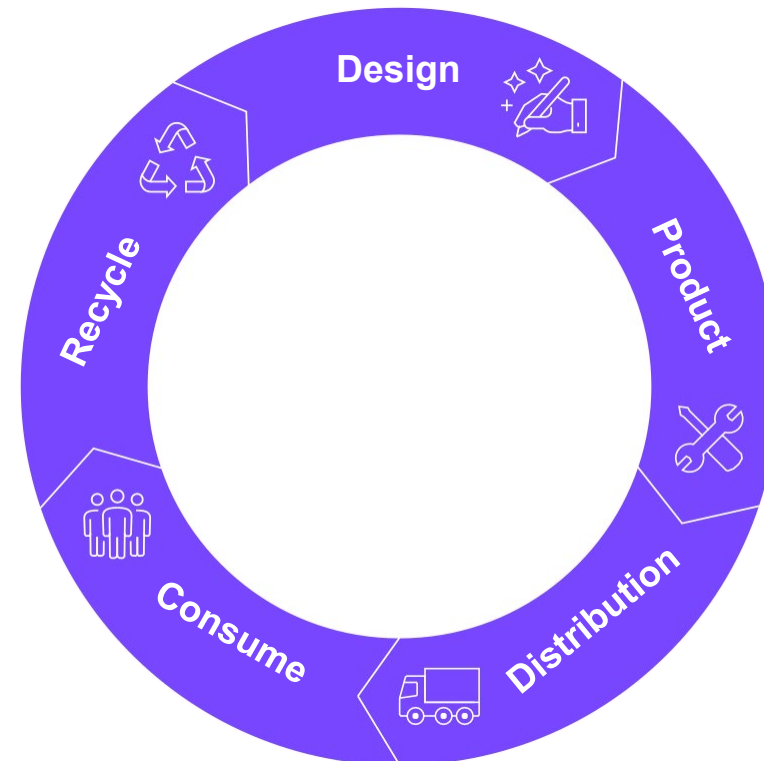

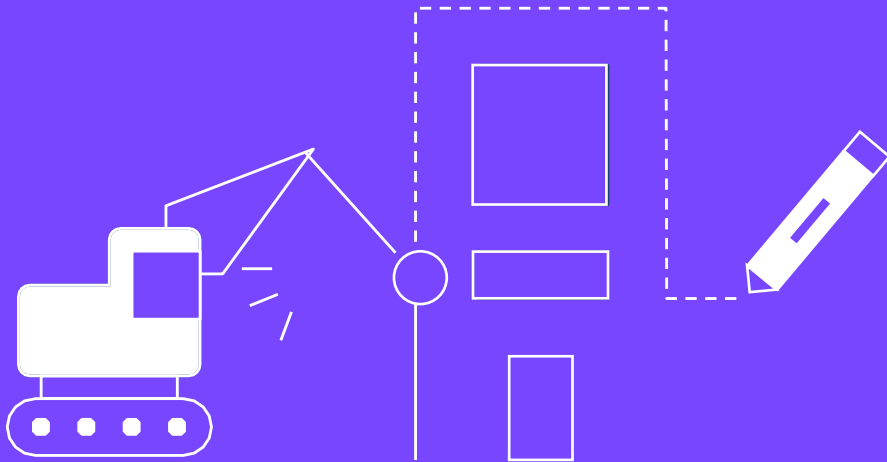

Act 1 Cradle to cradle® certification

We have certified nine systems, representing more than 40% of our annual product turnover, to Bronze level. In the coming years, we will expand and improve our C2C Certified product upto 60% of our product offering. And will have dedicated systems with Silver level certificates.

Act 2 Product (material) passports

By 2024, we will develop product passports for our systems. It will hold all the necessary information on material composition, maintenance, and disassembly.

Act 3 Recyclability

We will invest in our product design to improve recyclability, while partnering up with organisations in the field.

Company

Let's reduce our ecological footprint

The facts

The alarm bells are deafening, the evidence is irrefutable: we are at code red for humanity.

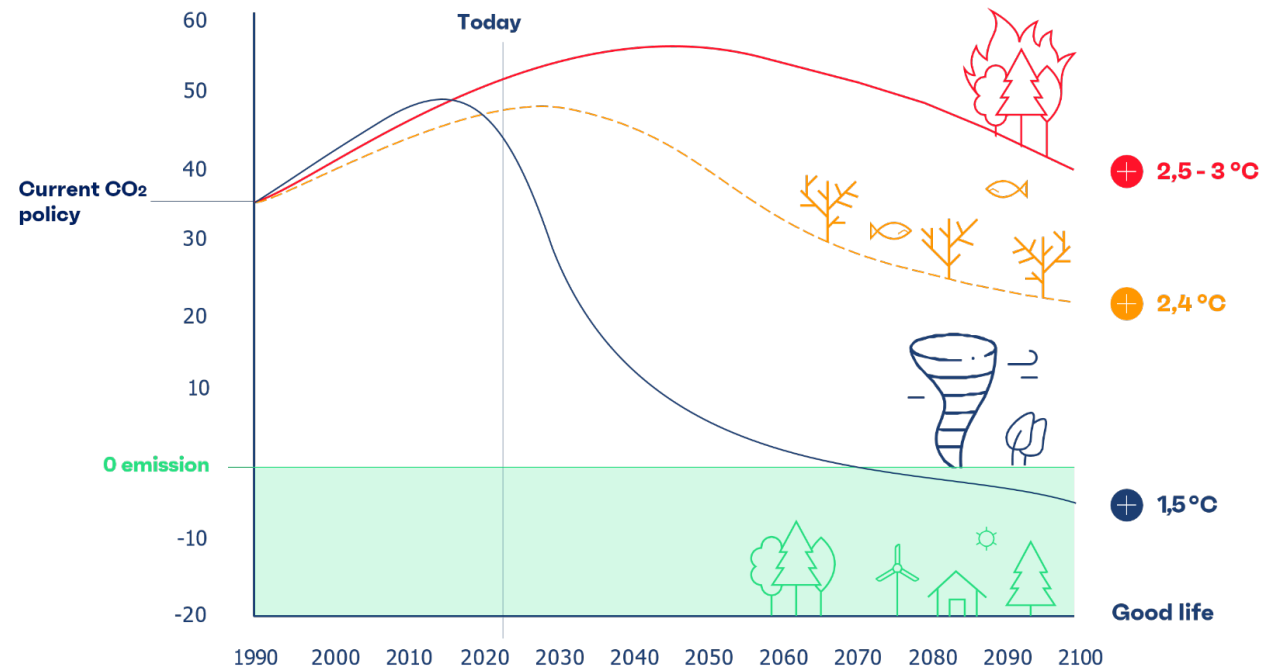

- ⊕ Extreme drought and fires
- ⊕ All coral reefs die
- ⊕ Extreme weather



Our actions

Scope 2

Indirect emissions from the generation of purchased energy

2,9%

Scope 1

Direct emissions from owned or controlled sources

0,8%



Scope 3

Indirect emissions from that occur in value chains including emissions upstream and downstream

96,3%

Scope 1 & 2

REDUCTION TARGET **-46%***

Scope 3

REDUCTION TARGET **-55%***

* relative reduction

* absolute reduction

Act 1 Reduce CO₂ emissions in our operations (Scope 1 & 2)

We are committed to reducing our direct CO₂-emissions by 46% by 2030 with focus on: Greener electricity use at our sites, greener company cars and with a greener coating procedure

Act 2 Reduce CO₂ emissions in our value chain (Scope 3)

We are committed to relatively reducing our indirect CO₂-emissions by 55% by 2030 through: Purchase of more recycled and low carbon primary aluminium, switch to green steel and recycled polyamide insulation strips.

Act 3 Improve our environmental management systems

Reynaers obtained the ISO 14001 certification and are taking the final steps towards receiving the ISO 50001 certification.



**Together
for better**